

Information and Communication Technology

Emergency Call Points



1.0 Emergency Call Points

Emergency Call points locations must be highly visible to the general public in a well lit area.

The call points are to be installed as:

- a) Free-Standing pillar OR
- b) Wall-Mounted

It is preferred that the builder install the wall mounted enclosure or free standing pillar with power and telephone cabling and ITS will install the electronics and face-plate.

The builder, consultant or contractor must liaise with MU ITS about the availability of the campus network to service the call point.

1.1 Wall-Mounted Call Points

- Call point may be wall mounted to the outside of buildings.
- The call point recess (enclosure) will start at a height of 800mm above ground level.
- Call points shall generally be recessed with the face flush with the wall, unless specified otherwise.
- Call points are mounted in an aluminium enclosure with dimensions of H 406mm x W 203mm x D 76mm.
- The appropriate aluminium enclosure can be obtained from ITS so that it can be installed during construction process by the builder.
- ITS will provide the appropriate face-plates (complete with graphics) at the same time as electronics are installed.
- Telephone cabling, and a mains GPO must be provided into the enclosure by the builder.
- ITS will install and activate the electronics on completion of the project.
- Refer to the related diagram for the Basic Schematic of enclosure and power and telephone layout.

Information and Communication Technology

Emergency Call Points

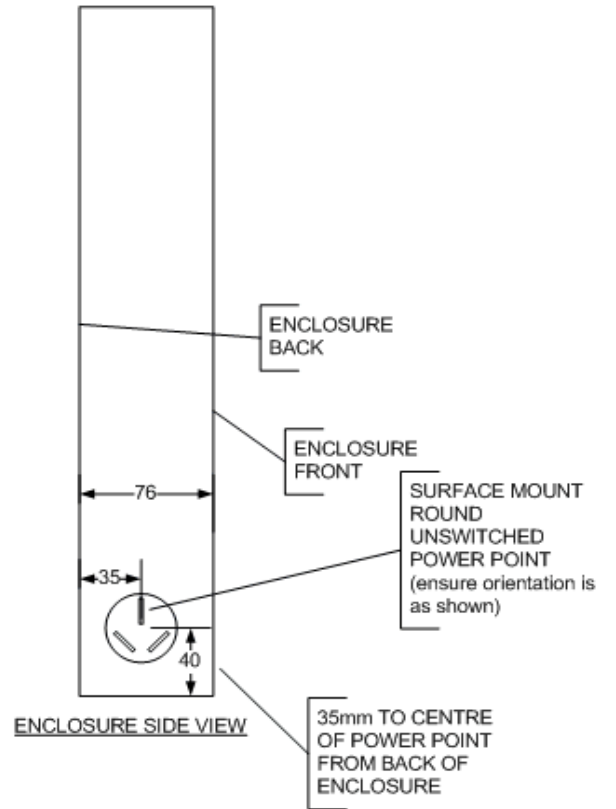
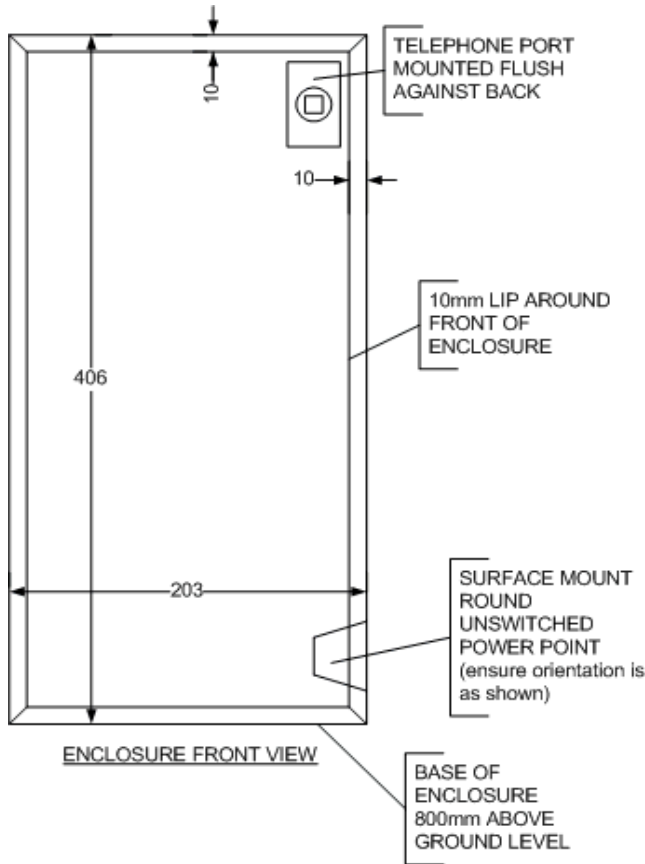

ENCLOSURE FRONT VIEW

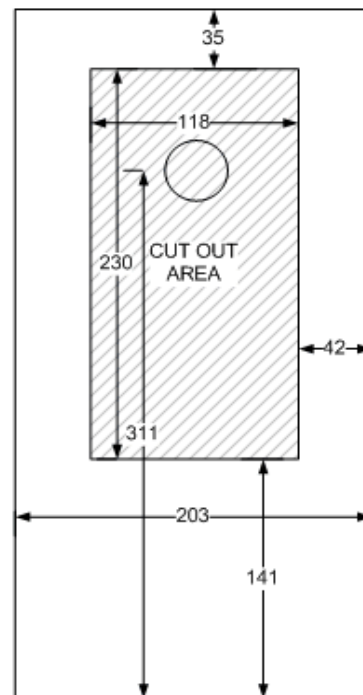

FACEPLATE FRONT VIEW

Information and Communication Technology

Emergency Call Points



1.2 Free-Standing Call Points

- Call points may be mounted in specially designed free-standing pillars.
- The Pillars are mounted onto a steel frame encased in concrete.
- The base of the pillar will be 112mm below ground level.
- It is the responsibility of the builder to install the pillar and associated frame during building construction.
- ITS will provide the Pillar, and the mounting frame, however 12 weeks notice must be provided prior to the planned installation date.
- Telephone cabling, and a mains GPO must be provided into the pillar by the builder.
- ITS will install and activate the electronics on completion of the project.
- Refer to the related diagram for the Basic Schematic of pillar and power and telephone layout

Information and Communication Technology

Emergency Call Points

